

Flat 4, Victoria House Vale Road

Brighton, BN41 1GG

Offers over £190,000

This superbly presented, one-bedroom apartment offers contemporary living in a highly convenient Portslade location, just moments from Portslade Railway Station and local amenities.

Occupying the top floor of a well-maintained building, the property features a bright and spacious open-plan kitchen and living area, with sleek cabinetry, integrated appliances and comfortable living and dining areas that are enhanced by characterful sloping ceilings and Velux windows that fill the space with natural light.

The well-proportioned double bedroom includes fitted storage and a large window. The modern shower room is finished to a high standard, featuring a walk-in shower, dark tiling, and contemporary fittings. Additional eaves and large loft storage provides valuable convenience.

Ideally positioned, the apartment is just moments from Portslade Railway Station, offering easy connections to Brighton, London, and beyond. Boundary Road’s array of shops, cafés, and restaurants are moments away, while Hove seafront is also within easy reach.

Perfect for first-time buyers or investors alike, this charming home blends modern comfort with a convenient location.



Vale Road

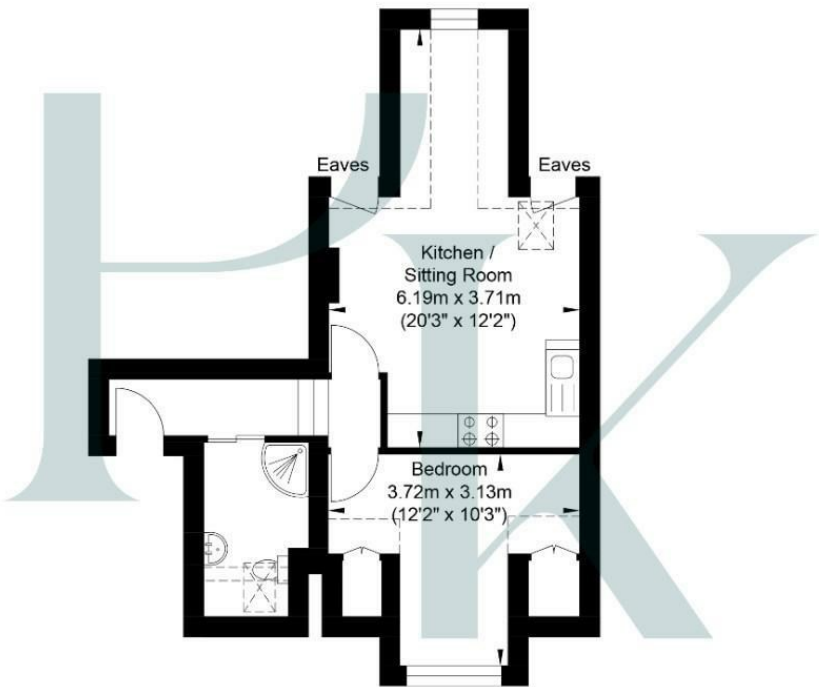

Second Floor
Approximate Floor Area
377.92 sq ft
(35.11 sq m)

Approximate Gross Internal Area = 35.11 sq m / 377.92 sq ft
Illustration for identification purposes only, measurements are approximate, not to scale.

Energy Efficiency Rating		
	Current	Potential
Very energy efficient - lower running costs		
(92 plus) A		
(81-91) B		
(69-80) C		
(55-68) D		
(39-54) E		
(21-38) F		
(1-20) G		
Not energy efficient - higher running costs		
England & Wales	EU Directive 2002/91/EC	

Environmental Impact (CO ₂) Rating		
	Current	Potential
Very environmentally friendly - lower CO ₂ emissions		
(92 plus) A		
(81-91) B		
(69-80) C		
(55-68) D		
(39-54) E		
(21-38) F		
(1-20) G		
Not environmentally friendly - higher CO ₂ emissions		
England & Wales	EU Directive 2002/91/EC	

Pearson
Keehan